



### Features

- Low profile & High Current capability
- Inductance range : 0.47 to 100μH
- AEC-Q200 qualified
- RoHS compliant

### Applications

- Automotive systems :
  - Driver assistant / Entertainment / Lighting
- DC/DC converters
- Power supplies
- Noise suppression for motors

## Molding Inductor - SPI Series(15mm)

### Electrical Specifications

Part Number	Inductance (μH)	DCR (Typical, mΩ)	DCR (Max, mΩ)	Saturation Rated Current (Typical, A)	Temperature Rise Current (Typical, A)
SPI-150-85-R47	0.47	1.0	1.5	60.0	35.0
SPI-150-85-1R8	1.8	2.5	3.5	35.0	28.0
SPI-150-85-2R2	2.2	2.8	3.7	35.0	27.0
SPI-150-85-3R3	3.3	3.6	4.5	34.0	24.0
SPI-150-85-4R7	4.7	4.8	5.5	34.0	20.0
SPI-150-85-6R8	6.8	8.3	11.0	34.0	15.0
SPI-150-85-8R2	8.2	9.9	12.0	32.0	13.0
SPI-150-85-100	10.0	13.8	15.0	26.0	11.0
SPI-150-85-220	22.0	31.7	45.0	12.0	7.0
SPI-150-85-330	33.0	45.0	55.0	9.0	6.0

### Characteristics

#### Standard Atmospheric Condition

- § Ambient Temperature : 25°C
- § Relative Humidity : 65%
- § Air Pressure : 1013 hPa

#### Operation Temperature

- § Operation Temperature -55°C ~ 155°C
- § As the product temperature rises due to self-heating, the margin must be taken into account.
- § Storage Temperature -55°C ~ 155°C
- § Resistance to Soldering Heat +245°C for 10 sec.
- § Temperature Rise +40°C typ. At rated | rms
- § Inductance Drop 20% typ.at | sat

### Identification

#### SPI-150-85-330

- ① ② ③ ④

- ① Product name, SMD Power Inductor
- ② Dimension Width, mm
- ③ Dimension Height, mm
- ④ Inductance, 330 = 33uH

### Product Dimensions

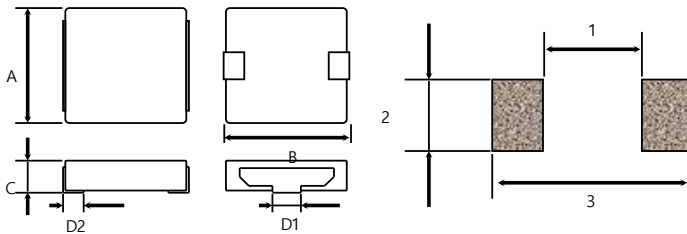

Series No.	A	B	C	D1	D2	1	2	3
SPI 150-85 Series	15.0±0.3	16.0±0.4	8.5 max	7.5±0.2	3.5±0.3	8.5	8.5	16.5

### Electrical Schematic

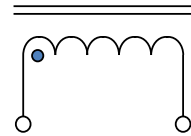

### Quantity Info.

- § Quantity per Reel : 300pcs
- § One box contains 4 reels(1,200pcs)
- In box contains 2 reels(600pcs)