

EMC FILTER PORODUCT

Model	Rated Voltage (V)	Rated Current (A)	Rated Power (KW)	Standard	SIZE (mm)						Fig
					A	B	C	D	E	F	
HO2WC-20XX	220	~10	1	SGSF	112	72	45	126	76	M4	2
NT03P4N-4XX	290~480	~100	50	SGSF / KC	285	250	170	142	175	M8	2
HO3WC-30XX HO3WC-40XX	290~480	~ 300	100	CE / FCC UL / SGSF	420	119	155	434	150	M10	2
HO3BC-30XX HO3BC-40XX	290~480	~ 600	250	CE / FCC UL / SGSF	335	145	100	470	150	5T	1
HOBC-3AXX HOBC-4AXX HOBC-4AXXDA	290~480	~1600	500	CE / FCC UL / SGSF	313	220	192	370	225	5T / 8T	1
					340	220	225	380	225	8T	1
HO3BC-3BXX HO3BC-4BXX	290~480	~2100	1000	CE / UL	473	225	192	619	225	10T	1
			1600		515	430	192	614	235	10T	1
HO3BC-4CXX HO3BC-4BXXOD	380~440	3600	2000	CE / UL	391	270	192	660	270	15T Double	1
			2000		453	230	202	736	235	10T Double	1
NHO3BC-4CXX	440	3600	2400		453	230	202	736	235	10T Double	

EMC FILTER PORODUCT

Model	Rated Voltage (V)	Rated Current (A)	Rated Power (KW)	Standard	SIZE (mm)						Fig
					A	B	C	D	E	F	
H300P-086X	290~1000	-	-	CE / FCC UL / SGSF	135	100	100	94	115	Φ53	3
T500P-101X	290~1000	-	-	CE / FCC UL / SGSF	150 ~210	117	114	110 ~170	134 ~194	Φ73	3
											3
H500P-140X	290~1000	-	-	CE / FCC UL / SGSF	190 ~250	160	160	120 ~180	160 ~220	Φ90	3
											3
H500P-168X	290~1000	-	-	CE / FCC UL / SGSF	190 ~250	182	176	120 ~180	160 ~220	Φ140	3
											3

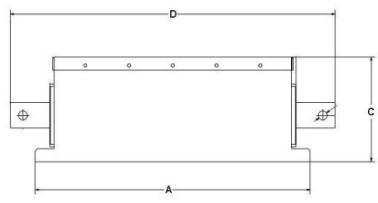

Fig 1 (Busbar type)

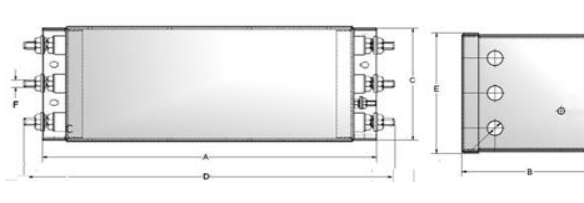

Fig 2 (Bolt type)

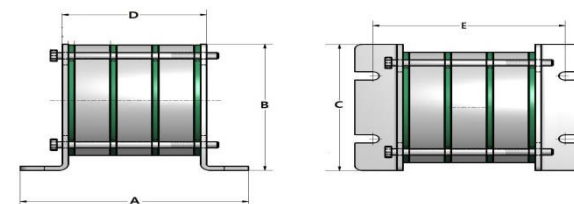

Fig 3 (FRAME TYPE)